

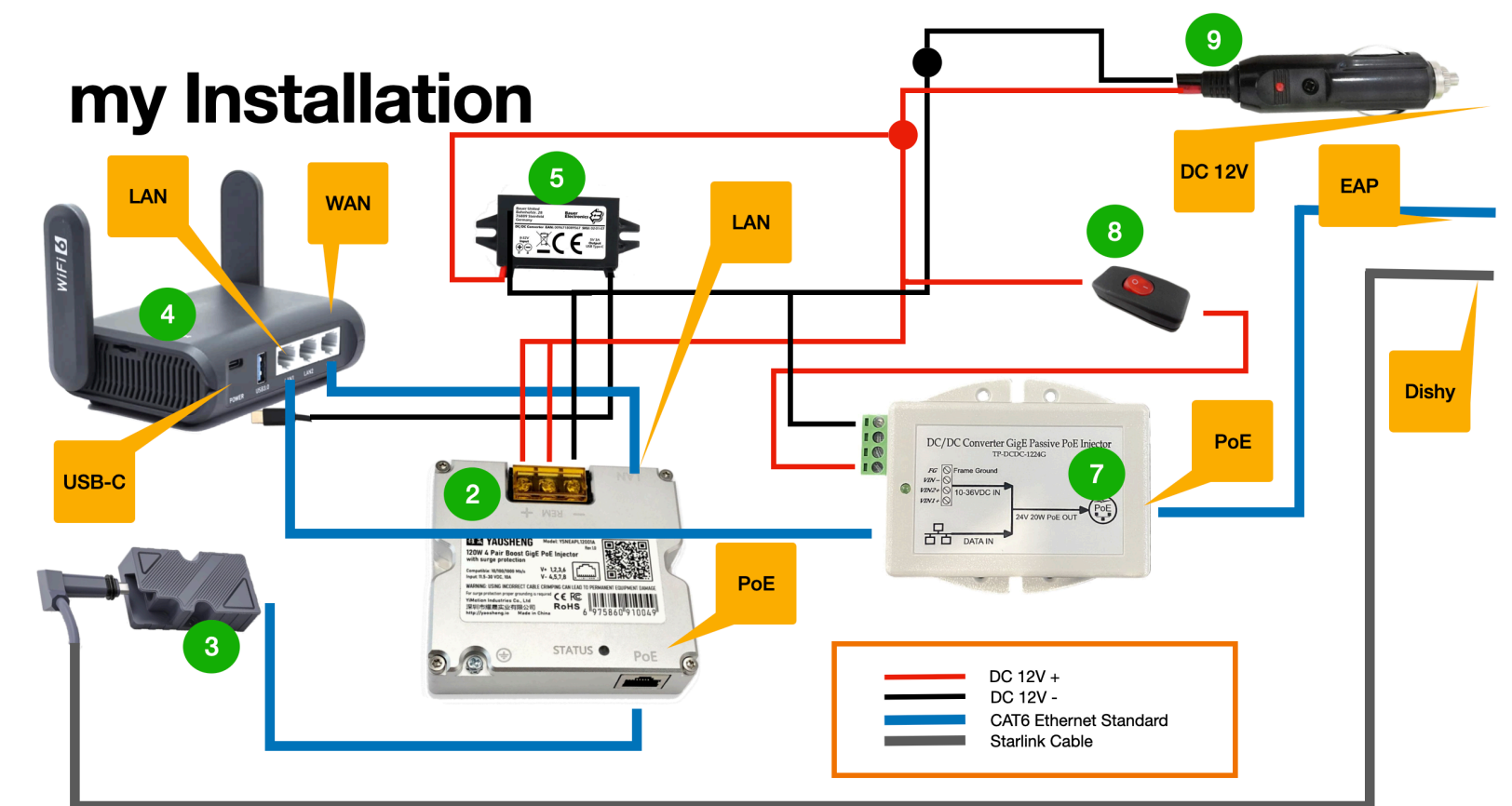

Starlink Standard Kit + EAP225 Outdoor Accesspoint

- keeping warranty of Starling Standard Kit (no cutting Starlink cable)
- flexibility in power supply (AC 220V and DC 12V)
- offering Wi-Fi, for example on a campground
- portability of the complete installation



Equipment

1. Starlink Standard Kit + Ethernet Adapter + Replacement Cable
2. YAOSHENG 120W Pair Boost PoE Injector to power Starlink Dish (input DC 11,5V - 30V 10A / output DC 48V)
3. Starlink Cable Adapter RJ45 (to avoid cutting Starlink cable)
4. GL-iNet AX1800 Wi-Fi 6 Travel Router (input USB-C 5V 8,75W 4A)
5. DC-DC Converter 12V 5V 3A USB-C to power GL-iNet AX1800)
6. tp-link EAP225 Outdoor Accesspoint (to offer Wi-Fi)
7. Tycon TP-DCDC-1224G to power tp-link EAP225 Outdoor (input DC 10V - 36V / output DC 24V 10W)
8. Switch to offer WiFi by tp-link EAP225
9. DC 12V Plug to power the complete Setup in a Car or RV
10. CAT6 Cables, DC12 V Cable and Connectors
11. Wooden Box

1. Starlink Dish, Cable, Router and Ethernet

I use the Starlink adapter only in AC 220V mode

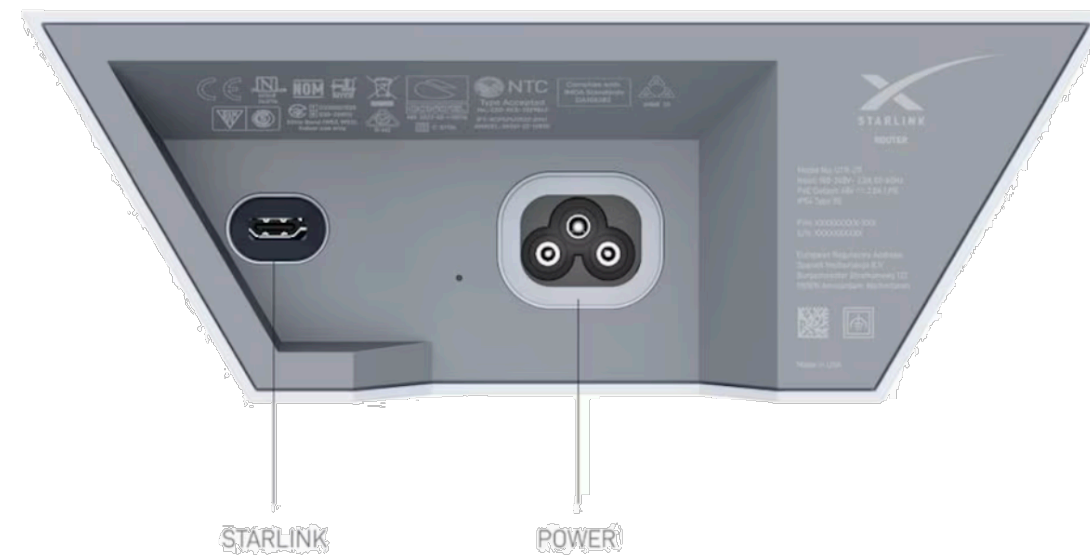

2. YAOSHENG 120W 4 Pair Boost PoE

2



I do not use a switch!

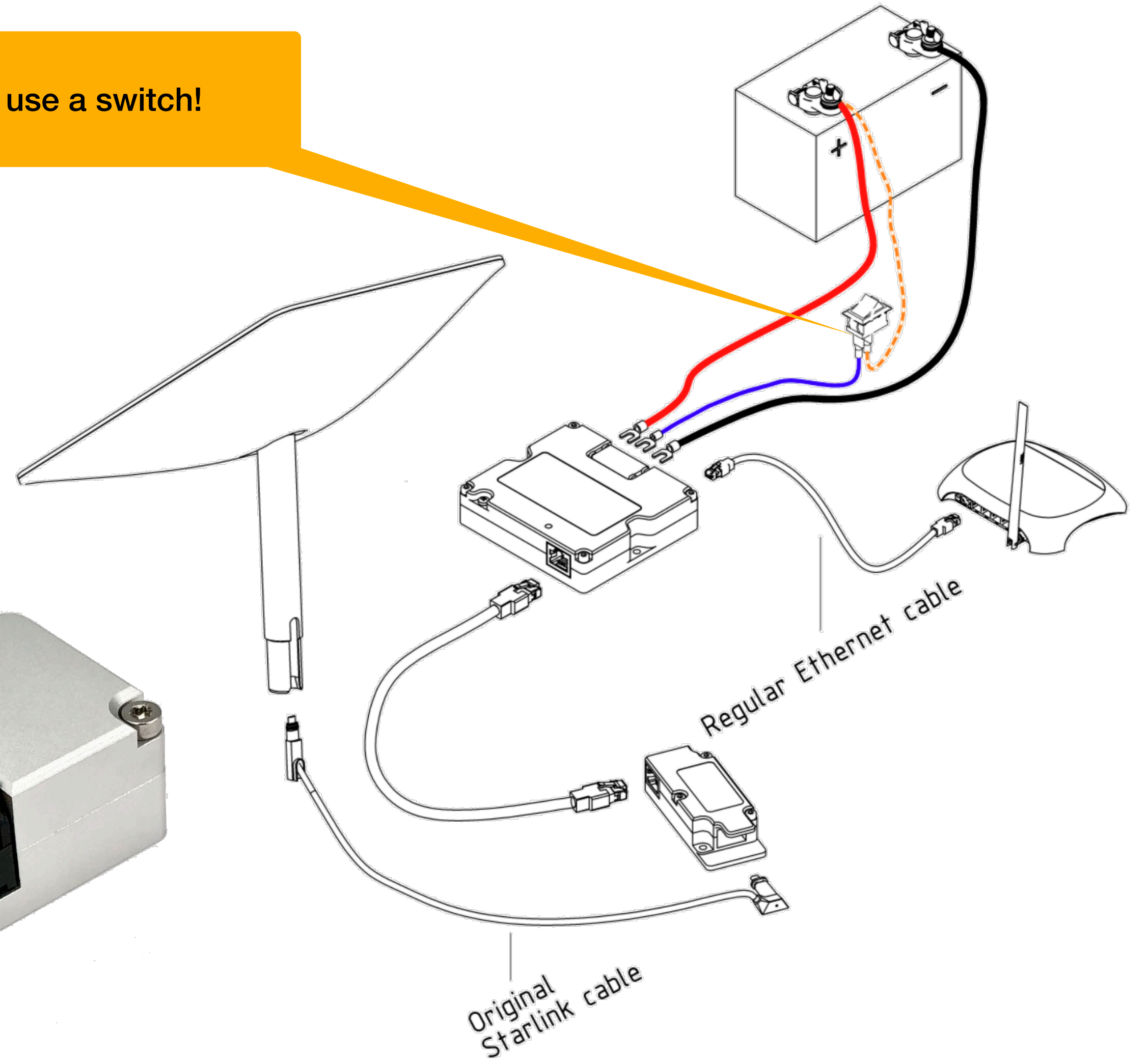

3. Starlink Cable Adapter RJ45

3

mount adapter in a position where you are able to remove cable easily



4. GL-iNet AX1800 Wi-Fi 6 Travel Router

4



5. DC-DC Converter 12V 3A 5V USB-C

5

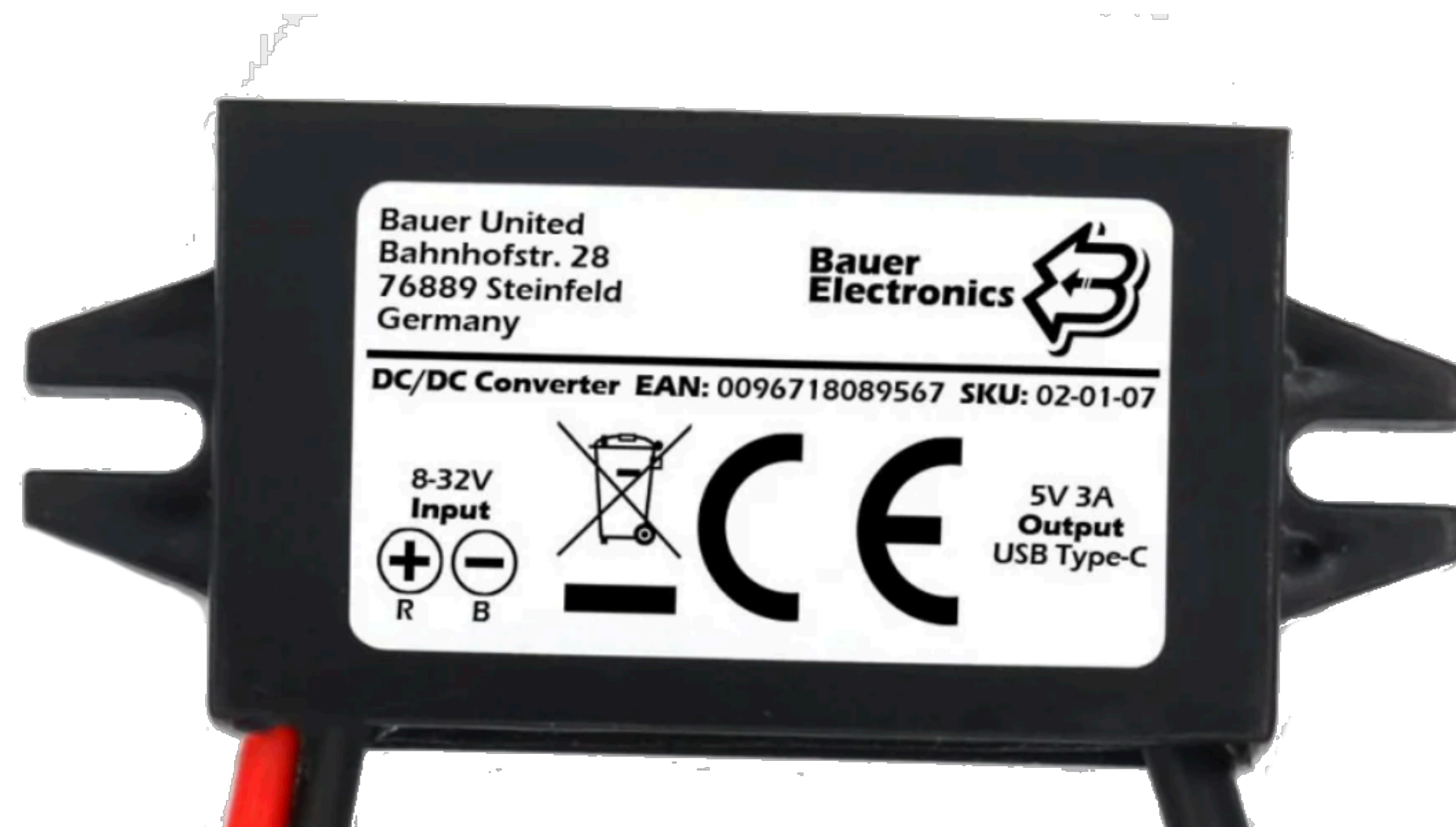
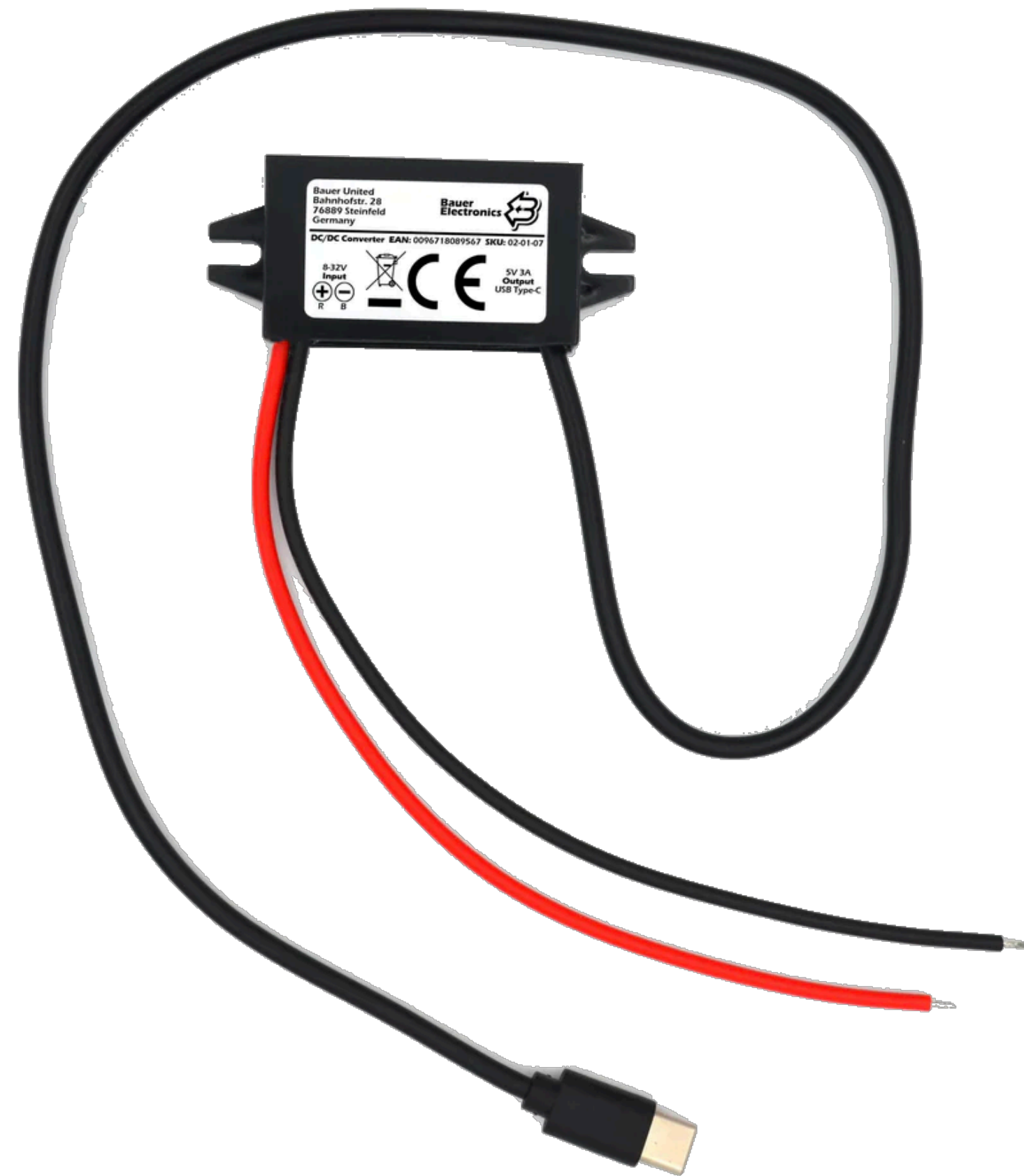

6. tp-link EAP225 Outdoor Accesspoint

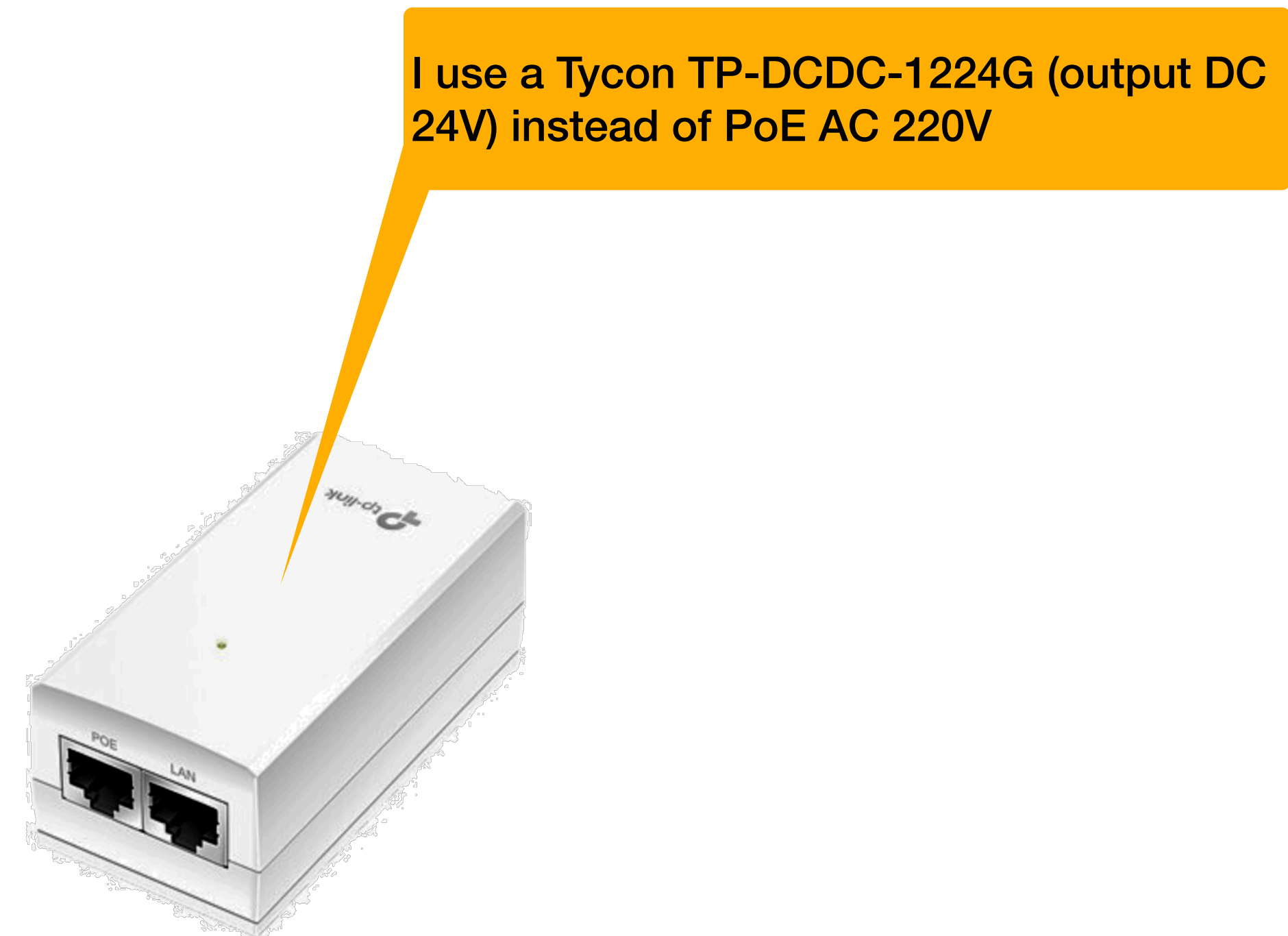

7. Tycon TP-DCDC-1224G

7

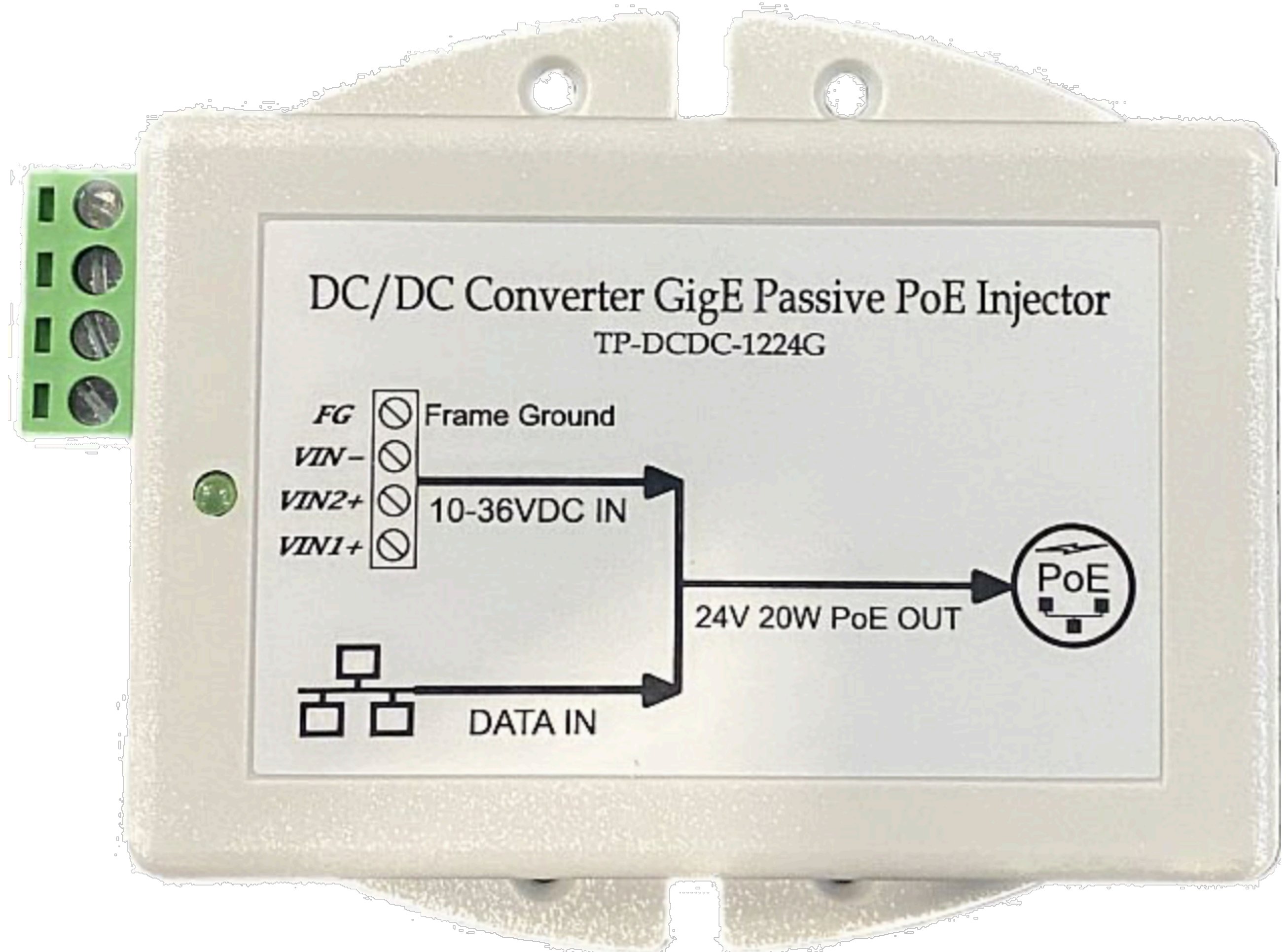

8. Switch 12V (to offer WiFi by tp-link EAP225)

8



9. DC 12V Plug (to power the complete Setup)

9



10. CAT6 Cables, DC12 V Cable and Connectors

1 x 50 cm Starlink Adapter to YAOSHENG Adapter PoE
1 x 50 cm YAOSHENG Adapter LAN to Router WAN
1 x 50 cm Router LAN to Tycon Data In (if needed)
1 x length depending on distance Tyson PoE to EAP225 (if needed)



2,5 mm² lenght depending on distance to DC 12V Plug in RV

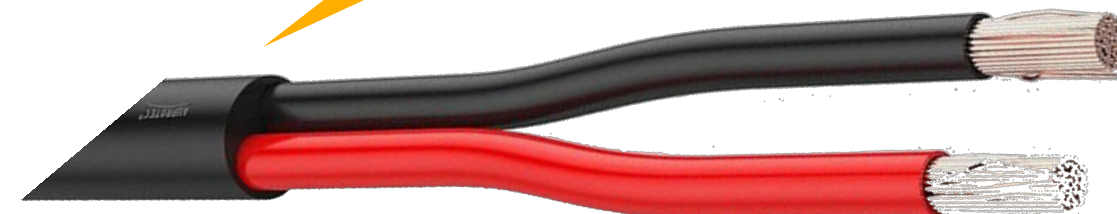

11. Wooden Box

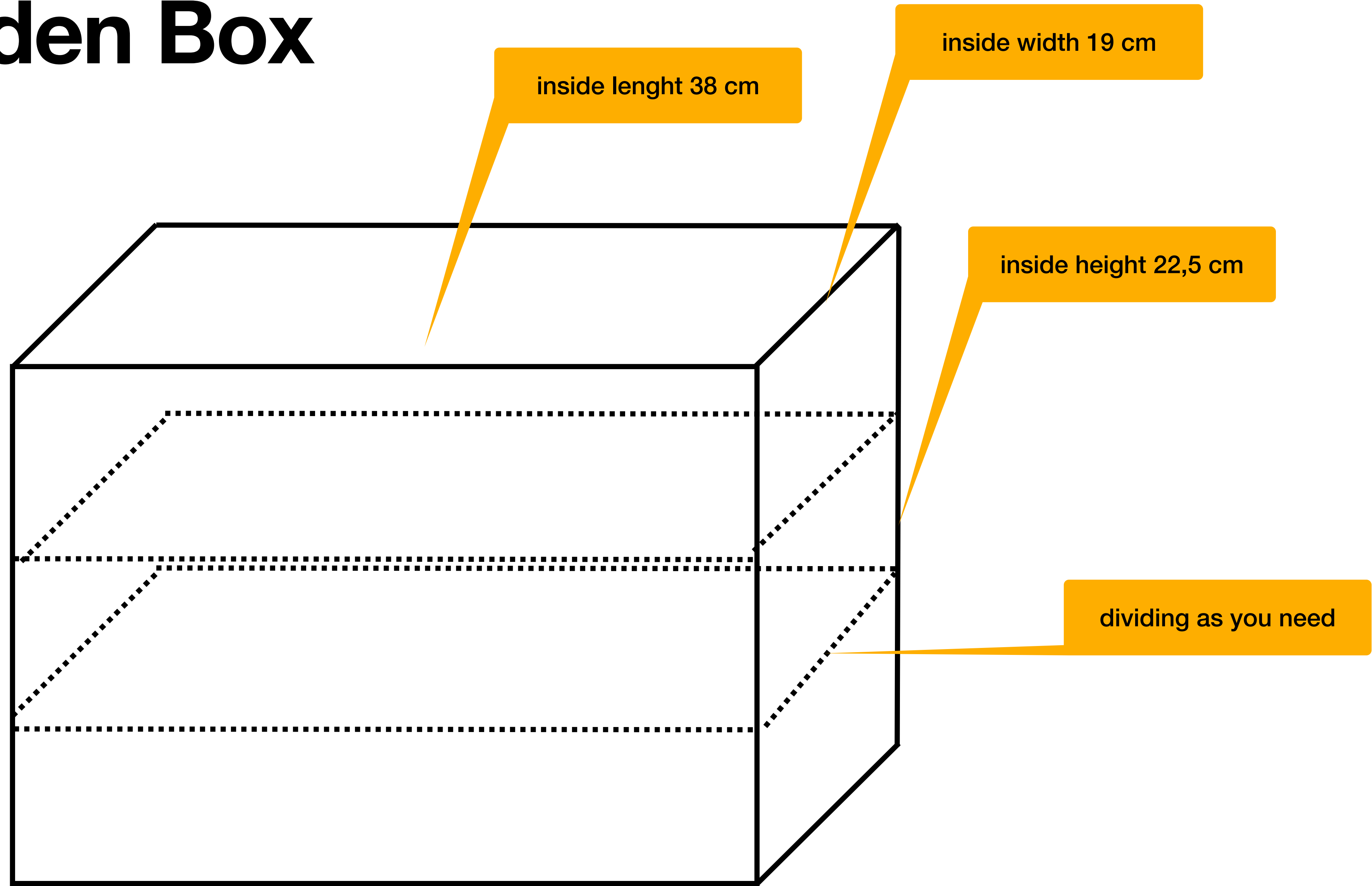

my Installation

